



47 Marsham Street, Westminster  
London SW1P

GARTON JONES.COM

47 Marsham Street, Westminster  
London, SW1P

GARTON JONES.COM

49 Marsham Street Sales +44 (0) 20 7340 0480  
London westminster@gartonjones.com  
SW1P 3DP www.gartonjones.com

£775 Per Week

We are delighted to offer this extremely well presented 2 bedroom apartment available to rent located on the 3rd floor (with lift) of this popular development in the heart of Westminster. The property is offered furnished and the property benefits from a fully integrated separate kitchen and a dual aspect reception room, there are 2 double bedrooms with fitted wardrobes and 2 bathrooms (1 en-suite). Additionally there is a 24 hour concierge and a residents on-site gymnasium. Romney House is just a short walk from the renowned local landmarks which include the Houses of Parliament, Westminster Abbey, Tate Britain Gallery and St Johns Smith Square Concert Halls offering a variety of classical musical performances. The local transport links of Victoria Station are nearby providing mainline UK services including the Gatwick Express as well as the underground services of Victoria, Pimlico, St James Park and Westminster. The area has an abundance of amenities in the immediate area and following on from the extensive regeneration of Victoria street a selection of many new restaurants to compliment existing. Distinguished hotels like The Wellington, The Goring, St Ermins', The Westminster are all within very close proximity. Garton Jones manage this property and are based on site

Council Tax Band F (London Borough of Westminster)  
Minimum Term 12 Months  
Deposit 5 Weeks  
EPC Rating B (81)

- 2 Bedroom Apartment
- 3rd Floor (With Lift)
- Dual Aspect Reception Room
- Integrated Separate Kitchen
- 2 Bathrooms (En-Suite)
- 24 Hour Concierge
- Available: 4th October 2025
- Close To Local Shops & Restaurants
- Walking Distance To St James's Park, Westminster & Victoria Transport Links



EPC certificate available on request.

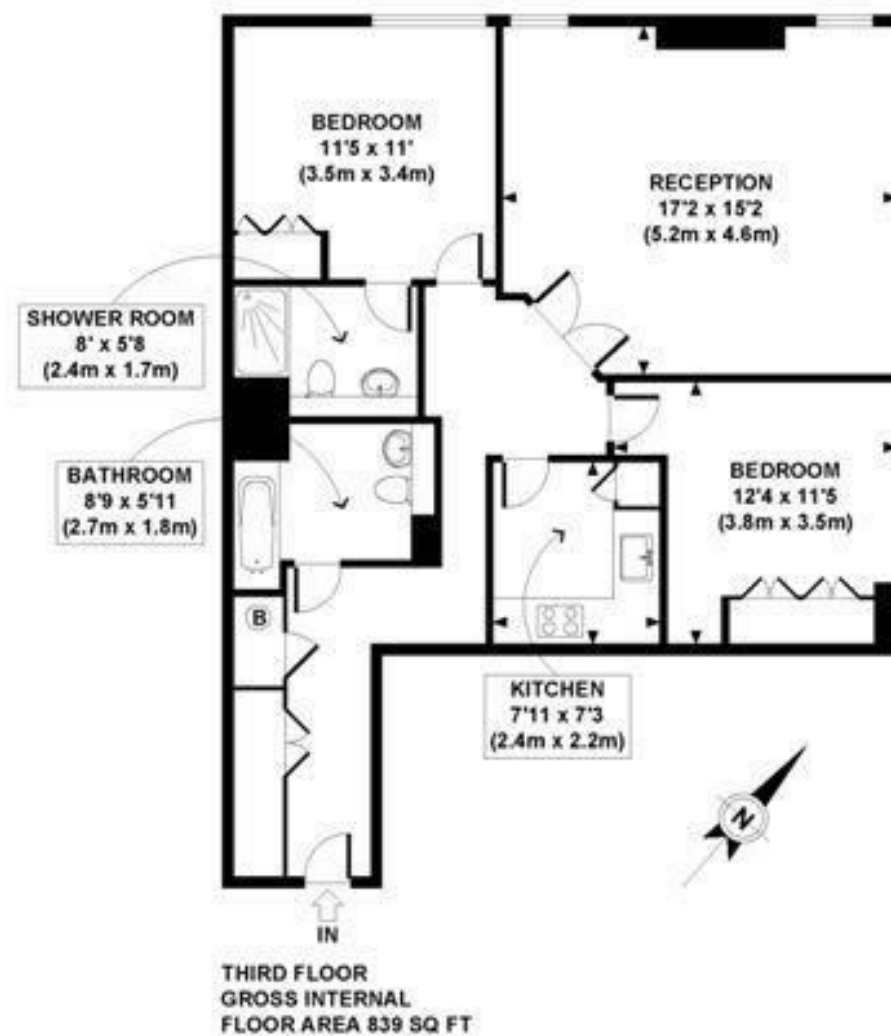

APPROX. GROSS INTERNAL FLOOR AREA 839 SQ FT / 78 SQ M  
SRGJW - 060308 Copyright [photoplan.co.uk](http://photoplan.co.uk)  
Floorplans are for identification and guideline purposes only, not to scale.  
Compliant with RICS code of measuring practice.



